

OPERATION INSTRUCTIONS

CH-404L / CH-505M MULTI TUBE BENDER

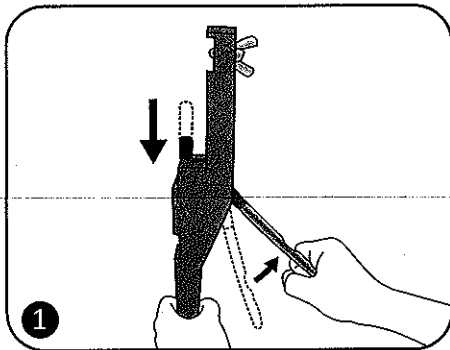

Release the lever to let rack return to the end.

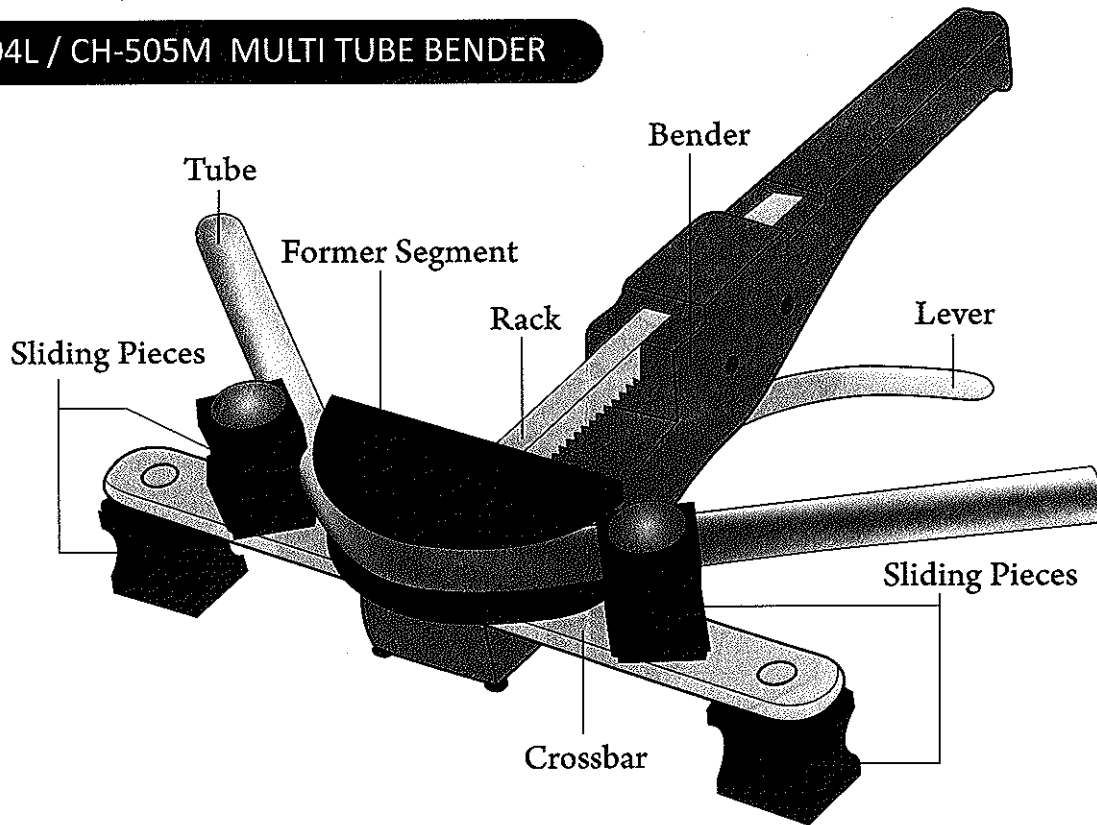
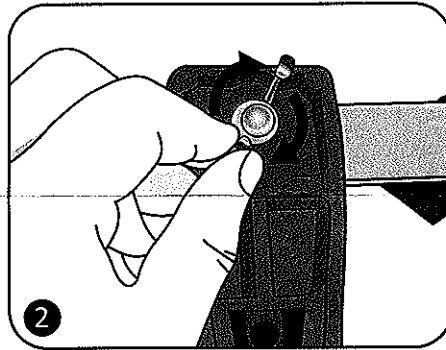

Put crossbar on the groove of the bender and lock the wing screw at the bottom of the bender.

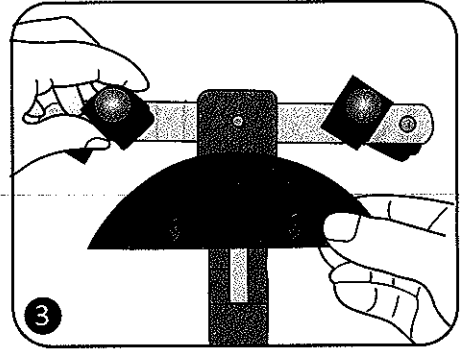

Insert former segment into the rack and turn sliding piece to the size want to be bent.

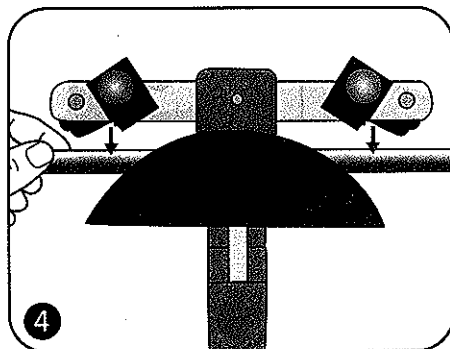

Insert the tube into proper position of former segment, press the lever to let rack to move forward and to start bending.

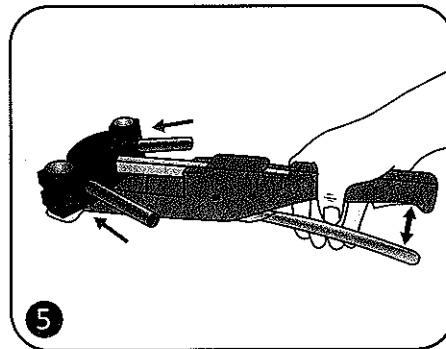

Bend tube to the angle needed.

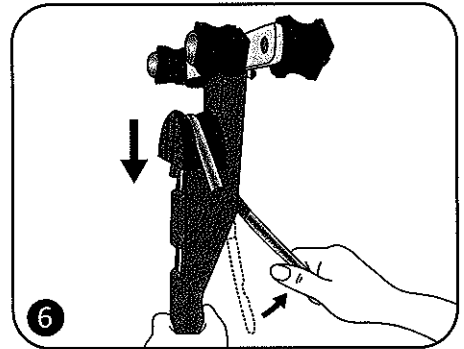

Release the lever to let former segment back and take tube out.

Note 1: Fit for over 0.8mm thickness copper tube, over 1/2" cooper tube must over 0.8mm thicknee. Otherwise, the copper tube is easy to be sunk after bendin.

Note 2: Suitable for soft copper tube. Hard copper tube must be soft annealed before bending.